

Self-Clinching Miniature Standoffs

Series CF40 & CF40S (Miniature Standoff)

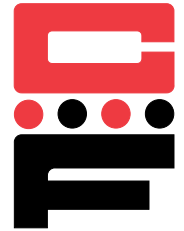

CF40 & CF40S Miniature Standoffs are designed to be used in limited space applications. They are ideal for securing D-sub connectors to enclosure backplanes and provide a flush mounting surface for RFI/EMI gaskets.

Series	Material	Finish
CF40	Heat-treated Carbon Steel	Zinc* Yellow
CF40S	300 Series Stainless Steel	Passivated ASTM A967

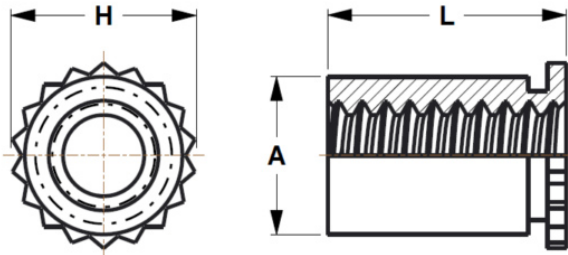

*See Finish Spec. on Page 6.

Thread: Internal 2B ANSI B1.1 (6H, ANSI/ASME B1.13M).

Use in: CF40 for Material with HRB-80 or less.

CF40S for Material with HRB-70 or less.

Part Number Structure:

CF40 - 440 - .250



All Measurements In Inches.

Dimensions & Specifications									
Thread Size	Part Number		L Length +.002 -.005 in.		+.003 -.000	A Dim. Max.	H Dim. (Nom.)	Min.	Min.
	Steel	Stainless Steel							
#4-40	CF40-440	CF40S-440	-.250	-.275	.166	.165	.194	.126	.037-.250

All Measurements In Millimeters.

Dimensions & Specifications									
Thread Size	Part Number		L Length +.05 -.13mm		+.08 -.00	A Dim. Max.	H Dim. (Nom.)	Min.	Min.
	Steel	Stainless Steel							
M3	CF40-M3	CF40S-M3	-6.35	-7	4.22	4.2	4.92	3.2	.94-6.35

Continued on next page.



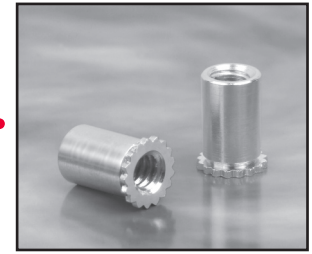

Self-Clinching Miniature Standoffs

Series CF40 & CF40S (Miniature Standoff)

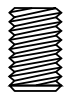
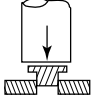
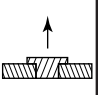
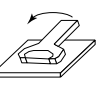

Continued from previous page.

Installation & Performance Data

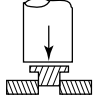
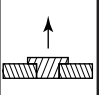
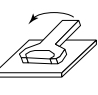
INCH (in.)	Sheet Material: .040 in. Cold-rolled Steel						Sheet Material: .040 in. 5052-H34 Aluminum						
						Rec. Tightening Torque Max. (in.-lbs.)						Rec. Tightening Torque Max. (in.-lbs.)	
	Thread Code	Material	Installation Force (lbs.)	Pushout (lbs.)	Torque-out (in.-lbs.)		Thread Code	Material	Installation Force (lbs.)	Pushout (lbs.)	Torque-out (in.-lbs.)		
440		Steel	1300	75	10	3.8	440		Steel	1000	50	10	3.8
		Stainless Steel	1300	75	10	3.8			Stainless Steel	1000	50	10	3.8

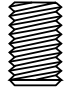
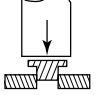
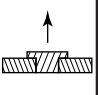
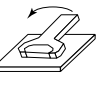
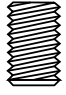
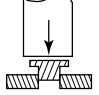
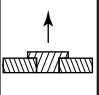
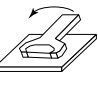
METRIC (mm)	Sheet Material: 1mm Cold-rolled Steel						Sheet Material: 1mm 5052-H34 Aluminum						
						Rec. Tightening Torque Max. (N•m)						Rec. Tightening Torque Max. (N•m)	
	Thread Code	Material	Installation Force (kN)	Pushout (N)	Torque-out (N•m)		Thread Code	Material	Installation Force (kN)	Pushout (N)	Torque-out (N•m)		
M3		Steel	5.8	334	1.1	.44	M3		Steel	4.5	223	1.1	.44
		Stainless Steel	5.8	334	1.1	.44			Stainless Steel	4.5	223	1.1	.44