



Self-Clinching Studs

Series HCW (Wide-Head)



HCW Wide-Head studs offer advantages over weld studs and other fasteners. The wide head configuration provides strong load bearing threads in materials as thin as .040 (1mm).

Series	Material	Finish *
HCW	Heat Treated Medium Carbon Steel	Zinc* Clear

*Spec. ASTM B633-85
 Thread: Class 2A, MIL-S-7742; (6g ISO metric)
 Use in: Cold-rolled Steel or 5052-H34 Aluminum with Rockwell Hardness of HRB-85 or less.

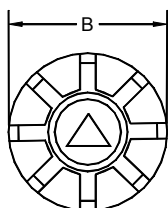
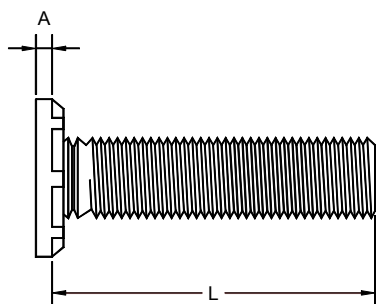

Part Number Structure:

HCW-1032-12

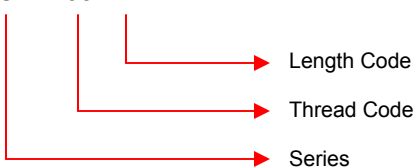

Dimensions & Specifications

INCH (in.)	Thread Size	Thread Code	L Length ± .015 in.						Min. Sheet Thickness	+0.005 -0.000	A Max	B ± .01	Max Hole in Attached Parts	Min. Dist Hole C/L to edge	
			.500	.750	1.00	1.25	1.50	1.75							2.00
	#10-32	1032	-8 [†]	-12	-16	-20	-24 [†]	-28 [†]	-32 [†]	.040	.190	.048	.357	.280	.360
	1/4-20	420	-8 [†]	-12	-16	-20	-24 [†]	-28 [†]	-32 [†]	.040	.250	.060	.462	.340	.470
	5/16-18	518	-8 [†]	-12	-16	-20	-24	-28 [†]	-32 [†]	.060	.312	.083	.586	.402	.560

Dimensions & Specifications

METRIC (mm.)	Thread Size	Thread Code	L Length ± 0.4 mm.						Min. Sheet Thickness	+0.13 -0.00	A Max	B ± 0.25	Max Hole in Attached Parts	Min. Dist Hole C/L to edge	
			15	20	25	30	35	40							50
	M5 X 0.8	M5	-15 [†]	-20	-25 [†]	-30	-35 [†]	-40 [†]	-50 [†]	1	5	1.35	9.6	7.3	10
	M6 X 1.0	M6	-15 [†]	-20	-25 [†]	-30	-35 [†]	-40 [†]	-50 [†]	1	6	1.52	11.35	8.3	11.5
	M8X1.25	M8	-15 [†]	-20	-25 [†]	-30	-35 [†]	-40 [†]	-50 [†]	1.5	8	2.13	15.3	10.3	14.5

† Not Stocked, available on special order.

Self-Clinching Studs



??

Continued from previous page.

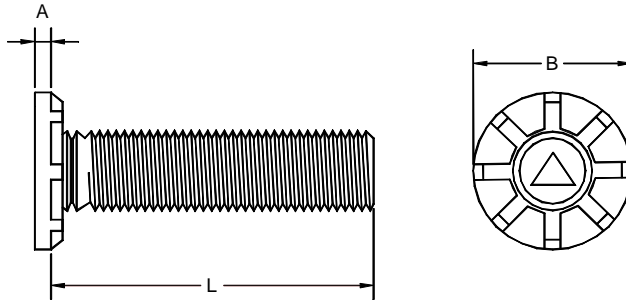
Series HCW (Wide-Head)

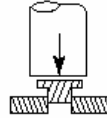
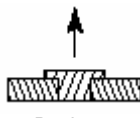

Installation & Performance Data

INCH (in.)	Thread Code	 Sheet Material & Thickness	Sheet Hardness HRB	 Installation Force (lbs.)	 Pushout (lbs.)	 Torque-out (lbs.)	Pull Thru (lbs.)
	#10-32	.040 Aluminum		27	7500	165	58
.040 Cold Rolled Steel			67	9500	295	58	2200
1/4-20	.040 Aluminum		27	8000	175	118	3200
	.040 Cold Rolled Steel		67	13500	335	128	3600
5/16-18	.060 Aluminum		22	9000	270	238	6000
	.060 Cold Rolled Steel		65	15500	570	288	6400

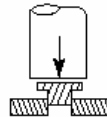
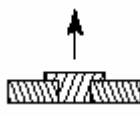
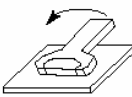
METRIC (mm.)	Thread Code	 Sheet Material & Thickness	Sheet Hardness HRB	 Installation Force (kN)	 Pushout (N)	 Torque-out (Nm)	Pull Thru (Kn)
	M5	1mm Aluminum		27	37.7	685	8.0
1mm Cold Rolled Steel			67	51.1	1345	8.0	10.6
M6	1mm Aluminum		27	39	745	11.7	14.2
	1mm Cold Rolled Steel		67	60	1395	14.3	15.5
M8	1.5 mm Aluminum		22	42	1225	23.4	25
	1.5 mm Cold Rolled Steel		65	71.1	2395	33.8	27.5

+ Not Stocked, available on special order.

??