



Self-Clinching Nuts

Series CKN, CKNS



CKN & CKNS self-clinching KAL-nuts provide strong internal threads in sheet material as thin as 1 mm. They are available in both heat-treated carbon steel and stainless steel material.

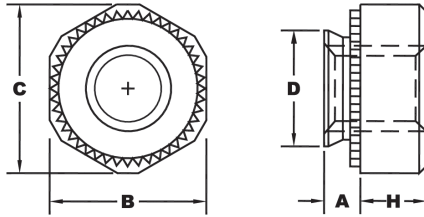

Series	Material	Finish
CKN	Heat-treated Carbon Steel	Zinc* Clear
CKNS	300 Series Stainless Steel	Passivated ASTM A380

*See Finish Spec. on Page 6.

Thread: Internal 6H, ANSI/ASME B1.13.

Use in: CKN – Materials with Rockwell Hardness of HRB-80 or less.
 CKNS – Materials with Rockwell Hardness of HRB-70 or less.

Dimensions & Specifications

Thread Size	Part Number		D Max.	B +.00 - .20	C Nom.	H ±.10	A Max.	Min.	+.08 - .00	Min.
	Carbon Steel	Stainless Steel								
M3 x 0.5	CKNM3-1	CKNSM3-1	4.45	5.5	5.7	2.0	1.0	1.0	4.5	4.5
	CKNM3-2	CKNSM3-2								
M4 x 0.7	CKNM4-1	CKNSM4-1	5.45	7.0	7.5	2.2	1.0	1.0	5.5	5.5
	CKNM4-2	CKNSM4-2								
M5 x 0.8	CKNM5-1	CKNSM5-1	6.45	8.0	9.2	3.0	1.0	1.0	6.5	6.5
	CKNM5-2	CKNSM5-2								
M6 x 1.0	CKNM6-1	CKNSM6-1	7.95	10.0	11.5	4.0	1.0	1.0	8.0	8.0
	CKNM6-2	CKNSM6-2								
M8 x 1.25	CKNM8-2	CKNSM8-2	9.95	13.0	15.0	4.5	1.4	1.4	10.0	10.0
	CKNM8-3	CKNSM8-3								

Installation & Performance Data

Thread Size	Shank	Min. Sheet	Cold-rolled Steel			Aluminum		
			Installation Force (kN)	Pushout (N)	Torque-out (N•m)	Installation Force (kN)	Pushout (N)	Torque-out (N•m)
M3	-1	1.0	12	600	2.0	6	400	1.2
	-2	1.4	13	900	2.5	7	700	1.5
M4	-1	1.0	13	700	3.0	8	500	2.0
	-2	1.4	14	1000	4.0	10	800	3.0
M5	-1	1.0	14	800	4.0	9	550	3.0
	-2	1.4	15	1100	5.0	11	850	4.0
M6	-1	1.0	17	1000	8.0	12	700	6.0
	-2	1.4	20	1400	12.0	14	1000	8.0
M8	-1	1.0	25	1500	16.0	16	1200	10.0
	-2	1.4	30	1900	20.0	18	1500	12.0